

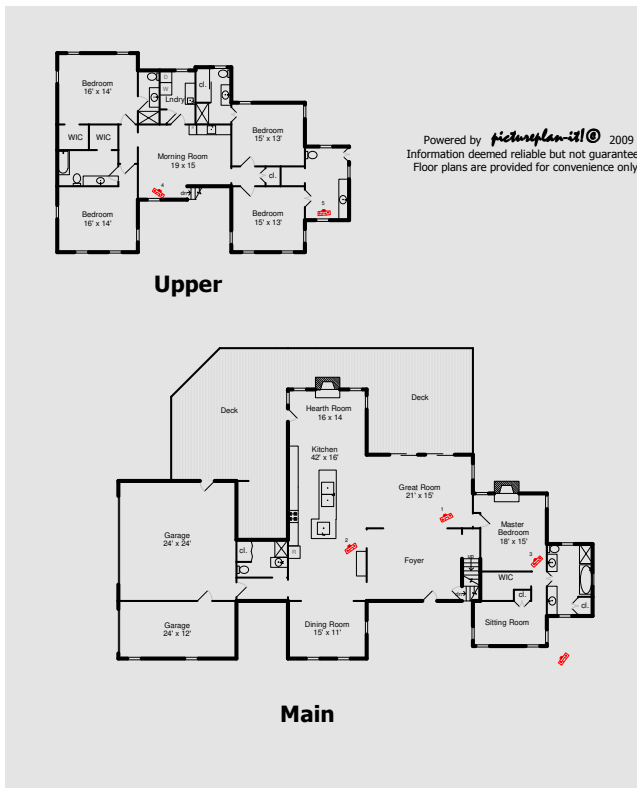

10342 S 700 West Rd, Edinburgh, IN 46124

Take a pictureplan-it! tour of this property.



Connie Percifield

connie@conniepercifield.com

812-343-3087

We never stop moving.



Over Please

Bedrooms: 5

Bathrooms: 6.5

Price: \$899,900

- Get alerted when your favorites are updated
- Organize and add notes to your favorites
- Single Family Property
- Status: Active
- Area: 7312-Shelby - Jackson
- County: Shelby
- Subdivision: Spt W2 Nw 30 11 6
- Year Built: 2008
- 5 total bedroom(s)
- 6.5 total bath(s)
- 6 total full bath(s)
- 1 total half bath(s)
- 13 total rooms
- Approximately 5647 sq. ft.
- Style: Historic, Traditional American
- Master bedroom
- Living room
- Dining room
- Family room
- Kitchen
- Basement
- Bathroom(s) on main floor
- Bedroom(s) on main floor
- Master bedroom is 18x15,Hardwood Floor,Main Level,Window Treatments,Double Sinks, Fireplace, Sitting Room, Whirlpool Tub
- Living room is 16x16,Hardwood Floor,Main Level,Window Treatments
- Dining room is 16x13,Hardwood Floor,Main Level,Window Treatments
- Family room is 19x15,Carpeting,Upper Level,Window Treatments
- Kitchen is 27x17, Hardwood Floor, Main Level, Window Treatments
- Basement level is 907 sq. ft.
- Hardwood floors
- 2 fireplaces
- Fireplace features: Located in Hearth Room, Located in Master BedRoom
- 3 car garage
- Attached parking
- Heating features: Heat Pump, Radiant/Floor, Propane Fuel, Gas WaterHeater
- Forced air heat
- Central air conditioning
- Cooling features: Central Electric, Heat Pump
- Exterior construction: Brick, Composite Siding Cement
- Lot features: Mature Trees, Wooded
- Approximately 10 acre(s)
- Lot size is between 10 and 20 acres
- Utilities present: Septic tank, Private Water Well, Gas Available, High Speed Internet Available
- School District: Southwestern CSC/Shelby